

Trilogy202



Quick start guide

- 1 Overview
- 2 Circuit setup
- 3 Setup screen
- 4 Prescription setup

1

Overview

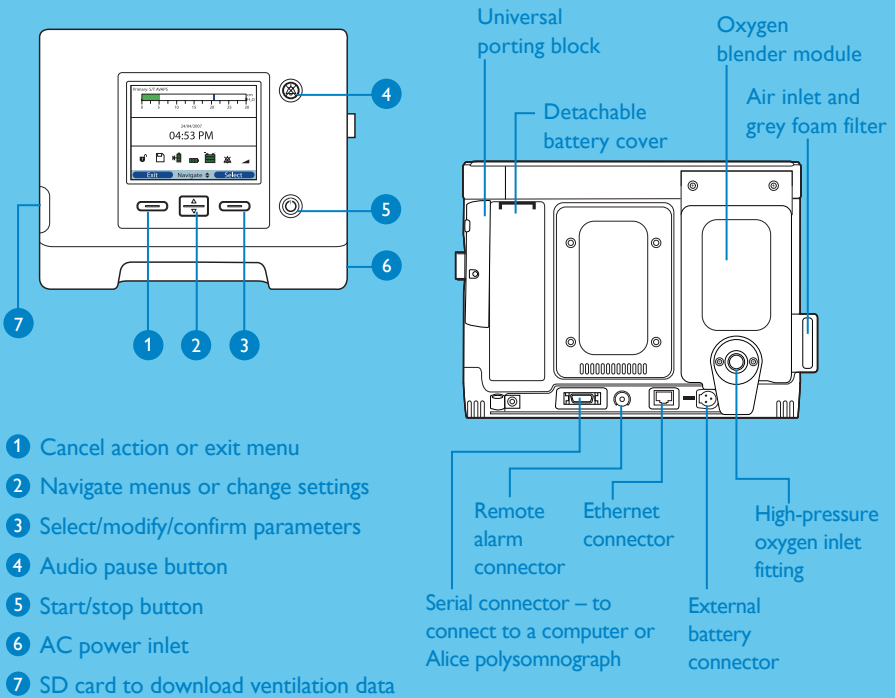

Symbols and icons



Full access mode



SD card inserted in the ventilator



Audio pause active



Ramp active



Status of optional detachable battery



Status of internal battery



Status of external battery



Battery is charging

2

Circuit setup

Before operating the Trilogy 202, you need to configure the circuit type.

Passive exhalation port circuit

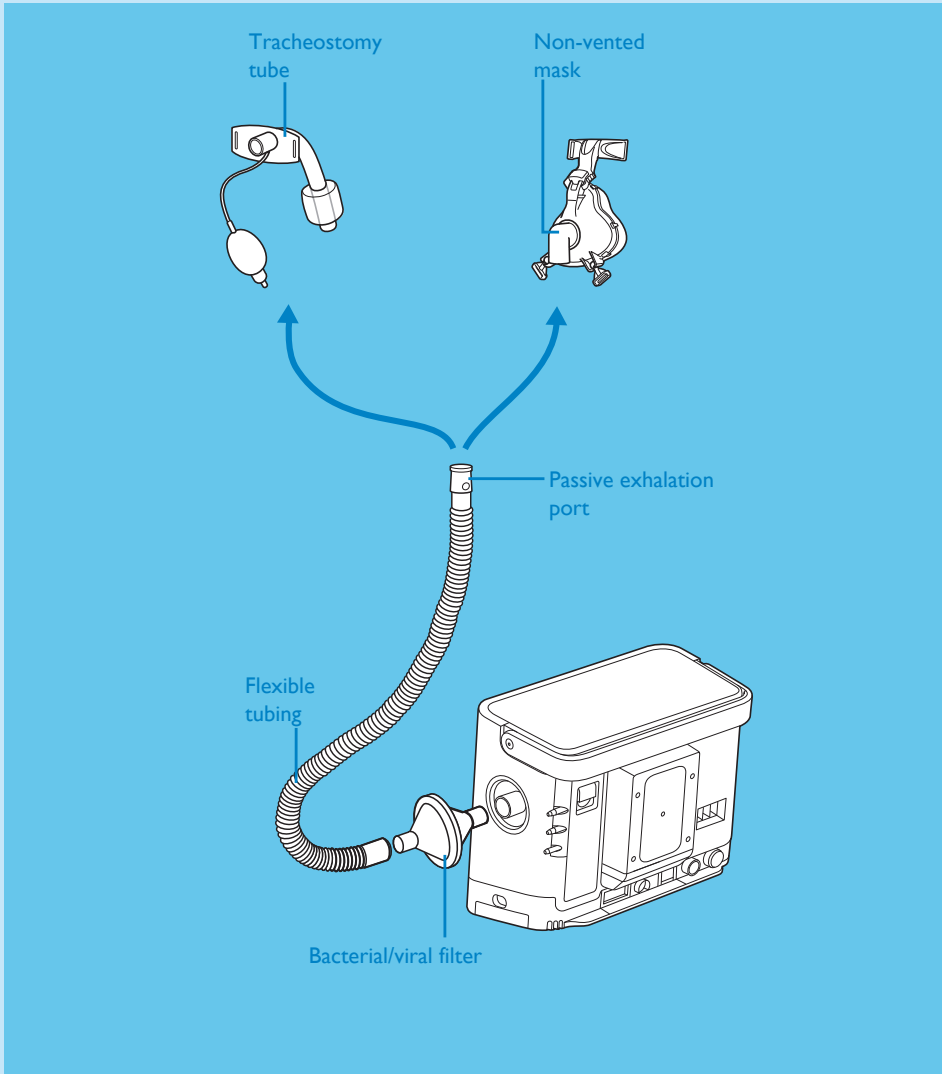

From the Setup screen select "Passive" for circuit type.

Active exhalation valve with proximal airway pressure circuit

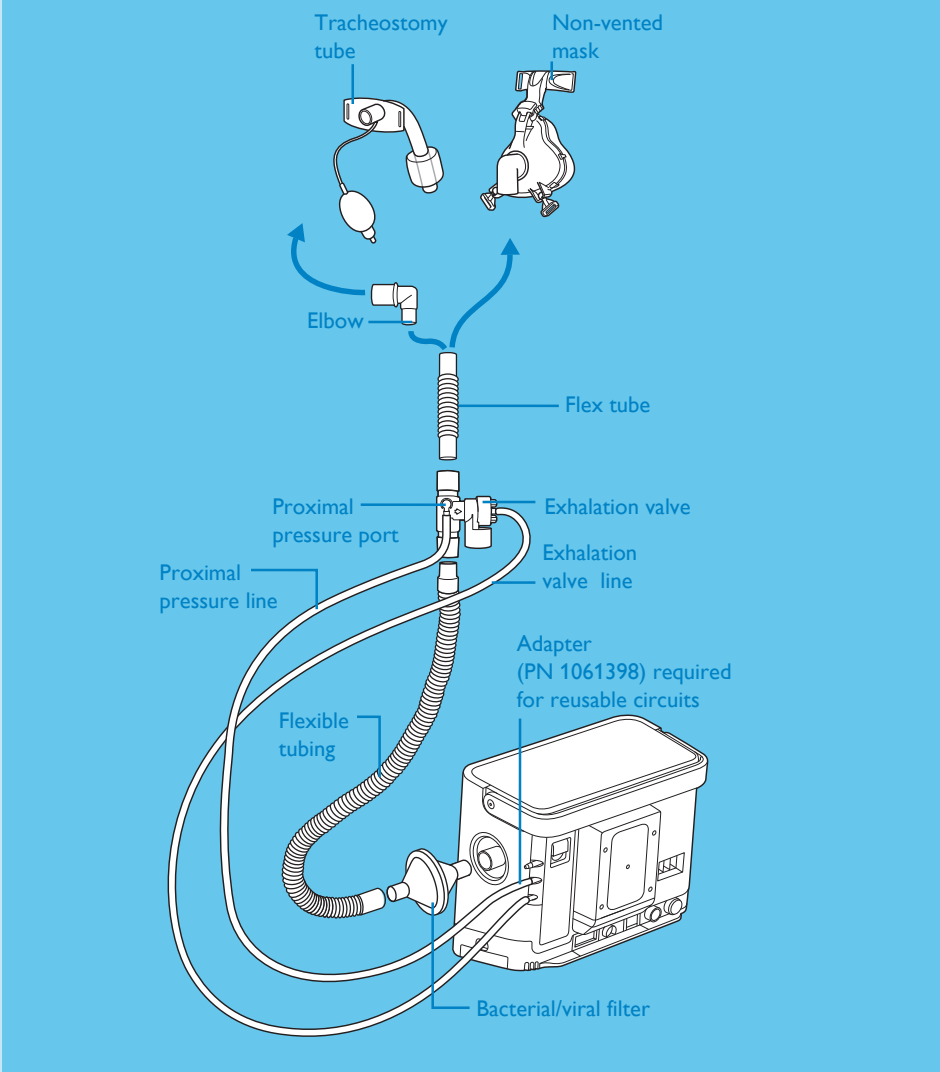

From the Setup screen select "Active PAP" for circuit type.

Active exhalation valve flow sensor circuit

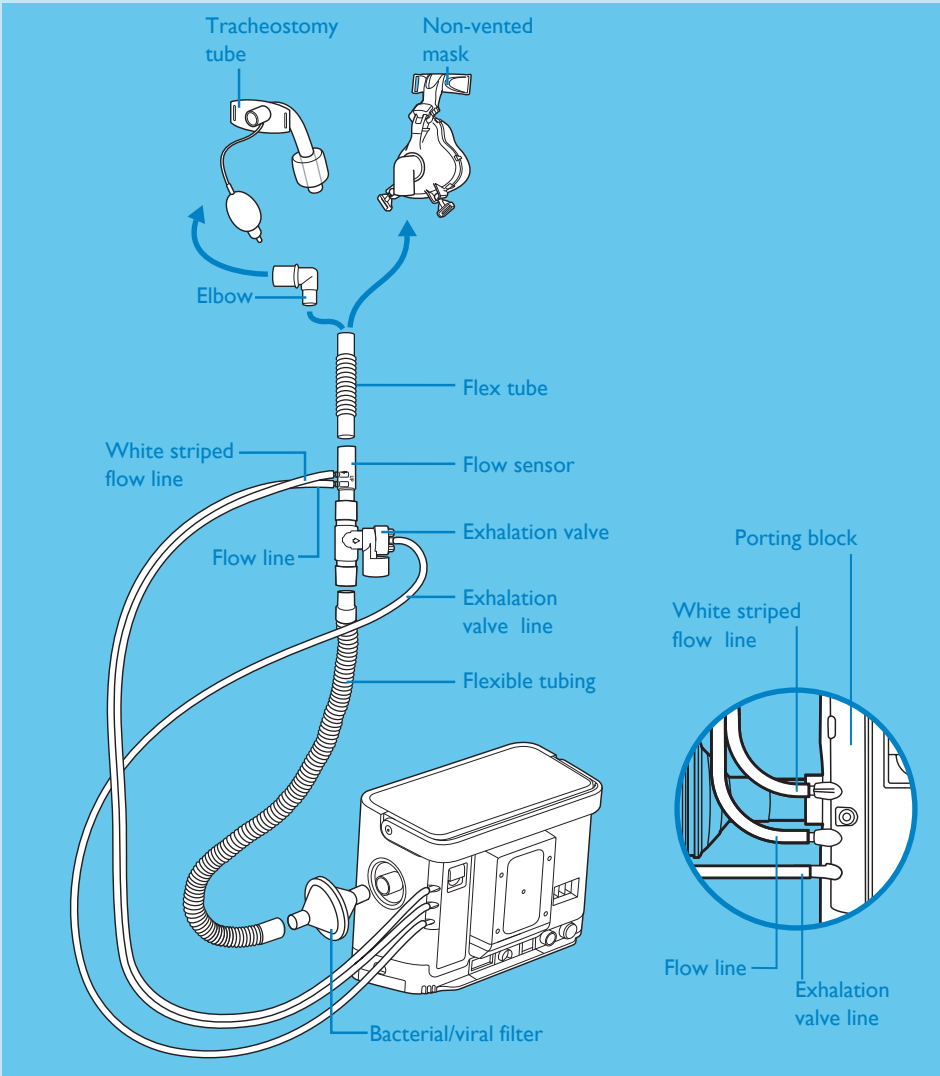

From the Setup screen select "Active flow" for circuit type.



3

Setup screen

Configuring the circuit type (active or passive)

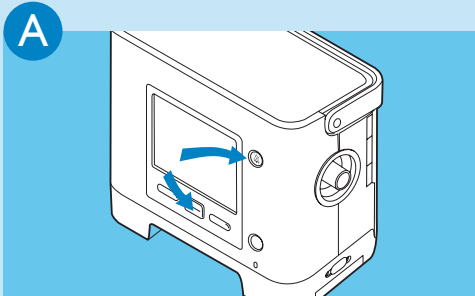
Make sure the Trilogy 202 is turned off before taking the following steps



Press and hold  and  for a few seconds to access the **Setup** screen

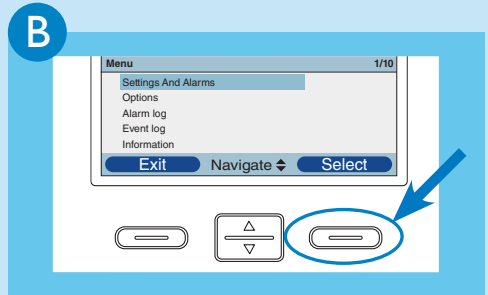

Select **Settings And Alarms**

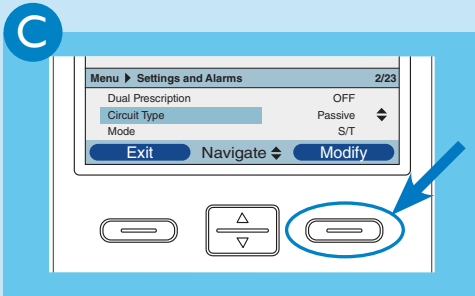

Navigate to **Circuit Type** and press 

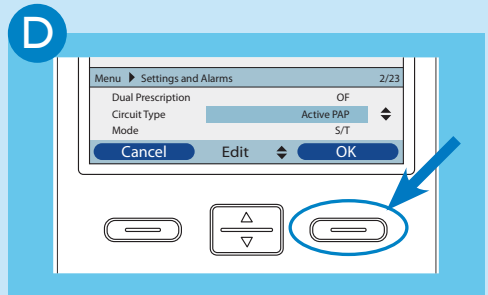

Use  to choose **Active PAP**, **Active flow**, or **Passive** and then press  twice to confirm

Setting menu access (May be performed while on or off the patient)

To enable full access to the settings

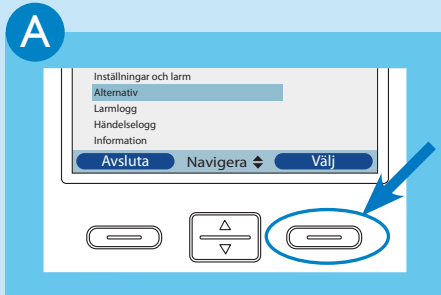

Navigate to **Options** and press **Select**

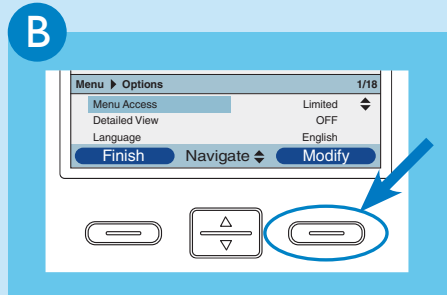

Press **Modify** to enter **Menu Access**

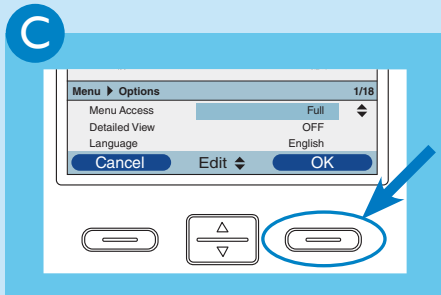

Use **▲ ▼** to choose **Full** or **Limited Access** and press **OK** to confirm

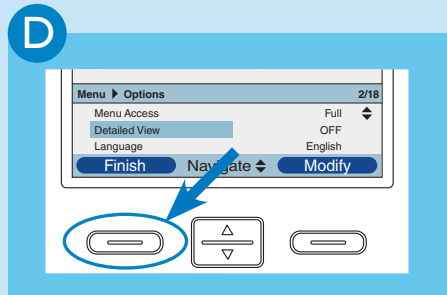

Press **Finish** and **Exit** to return to **Initial Screen**

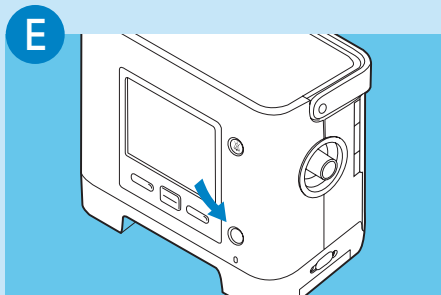

Press **⏻** to begin therapy **or** continue navigating through the menu to set up the ventilation parameters

4

Prescription setup

A

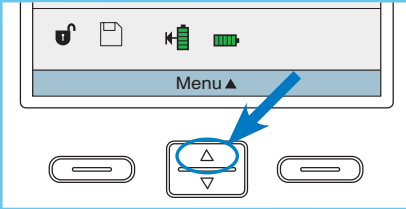

From main screen, press **Menu**

B

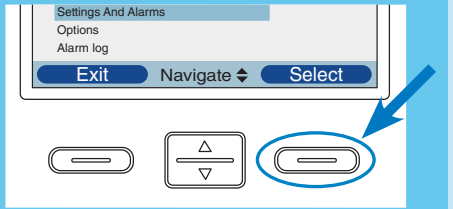

Select **Settings And Alarms**

E

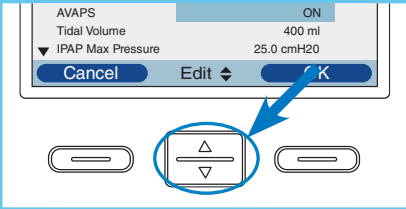

Use  to change the value or status of setting

F

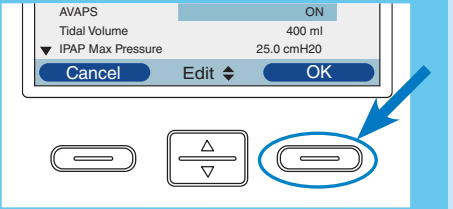

Press **OK** to validate new setting

Dual Prescription

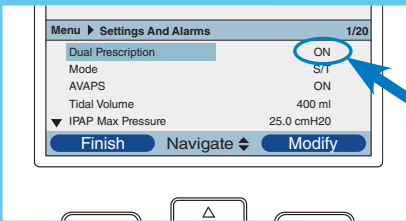

If **Dual Prescription** is enabled, both prescriptions need to be adjusted as previously explained

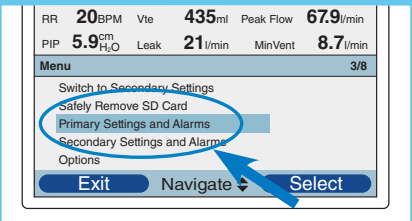

Set both primary and secondary prescriptions

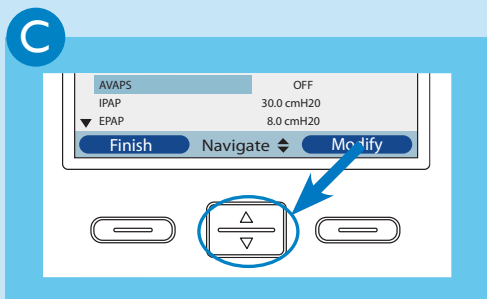

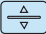
Scroll up and down using  to navigate through the settings and alarms

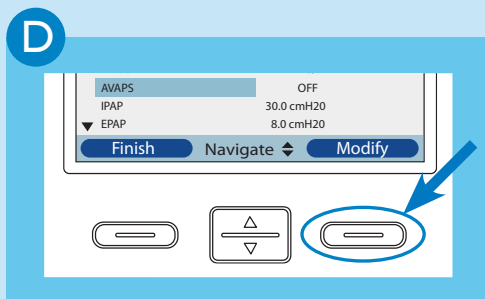

Press **Modify** to change the parameter highlighted in blue

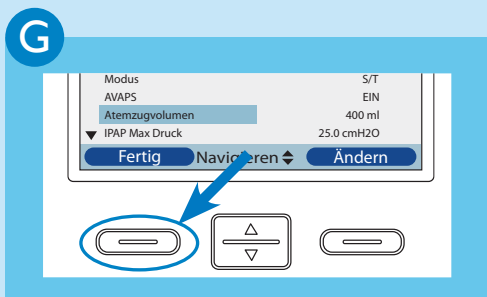

Press **Finish** and **Exit** to return to the main screen

Respironics Inc.
1001 Murry Ridge Lane
Murrysville, PA 15668 USA



Respironics Deutschland
Gewerbestr. 17
82211 Herrsching, Germany



1068642
JH 1/28/10